

Model Farm Project

a partnership between



Aerial view of the whole farm

The farm is made of people

At present the property is in the planning process and re-structuring of the basic facilities. The maintenance of the physical property is a very important process. The formation of a team of people able to meet the challenges of a large project with great responsibility and high expectations is our major concern. We must remember that the farms are made by people, not only for animals, if we are to have a profitable property, the recruitment and training of a good team is essential. With that in mind, FAI - Brazil has already taken the first steps and hired an , hiring the Agricultural Technician Cleverson Bonarte and is investing time and resources in social and professional training. In addition to animal welfare the welfare of people working on the farm is important.

The Farm

The Santa Terezinha Farm, on the side of the Mogi Guaçu River in the town of Jaboticabal, state of Sao Paulo. The farm is about 350 kilometers from Sao Paulo (capital) and only 40 kilometers from Ribeirao Preto city, one of the largest agroindustrial regions in the country. With its 140 h of total area, the farm is divided into sugar-cane, forest reserves and farm buildings. Established in an old distillery of sugar cane, the Santa Terezinha farm has a training centre with two fully equipped classrooms, more than 40 houses, 5 storage sheds and offices, cattle handling facilities, electrical installations, and good quality water supply. After some repairs the farm will be able to will be able to host people interested in the development of high welfare, economically viable livestock productions systems

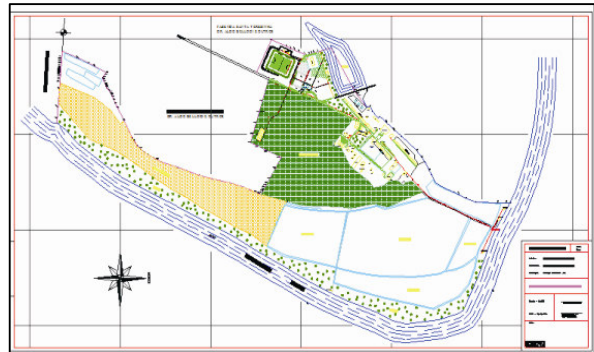

The Farm Map

Activities on progress:

- Professional development of the staff.
- Purchase of equipment.
- The Project of production of broilers open-air.
- Establishing partnerships with public and private institutions.